

Assembly Instructions

Q20 - Beam

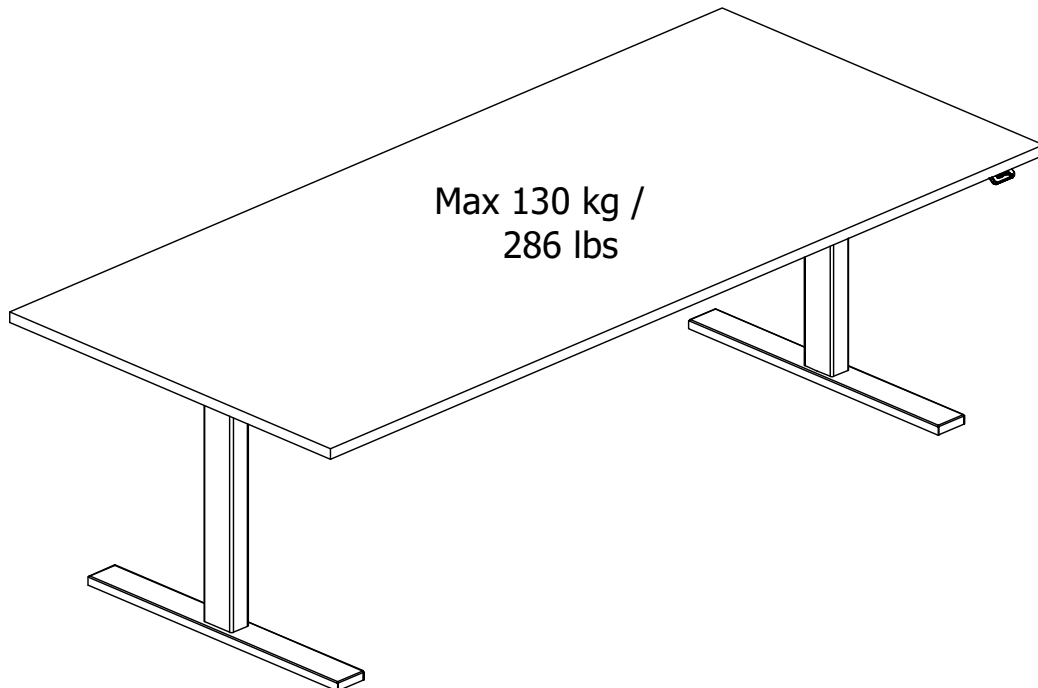

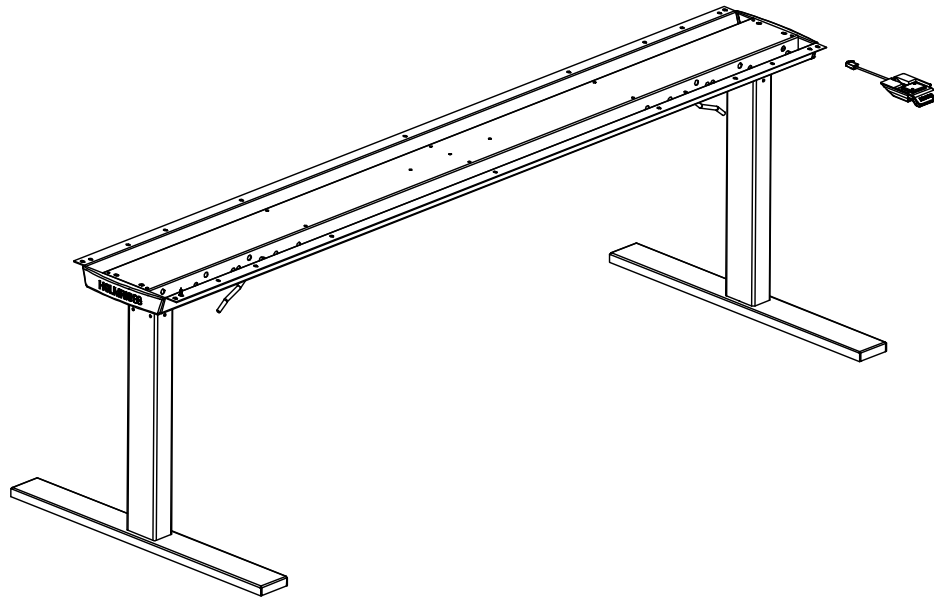
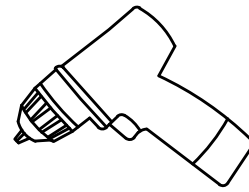
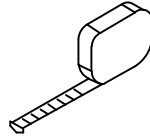
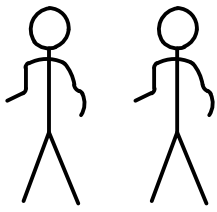

26 xA



Ø4,5 x 16 mm
Ø 0.18" x 0.63"

2 xB



Ø4 x 30 mm
Ø 0.16" x 1.18"

1 xC

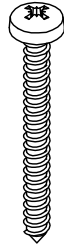

Ø4,5 x 45 mm
Ø 0.18" x 1.77"

8 xD

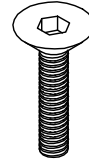

M6 x 25 mm
M 0.24" x 0.47"

1 xE

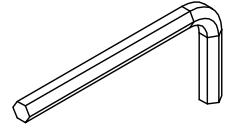

2 xF

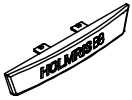

2 xG

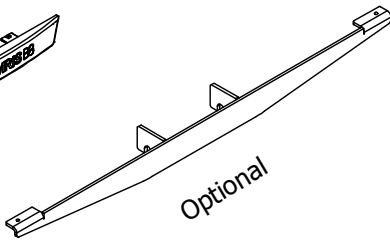

4 xH

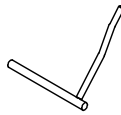

2 xI

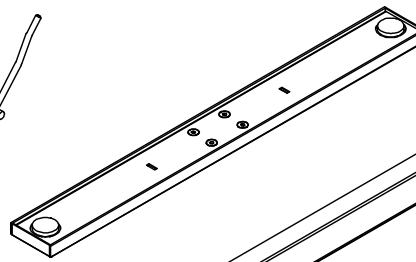

1 xJ

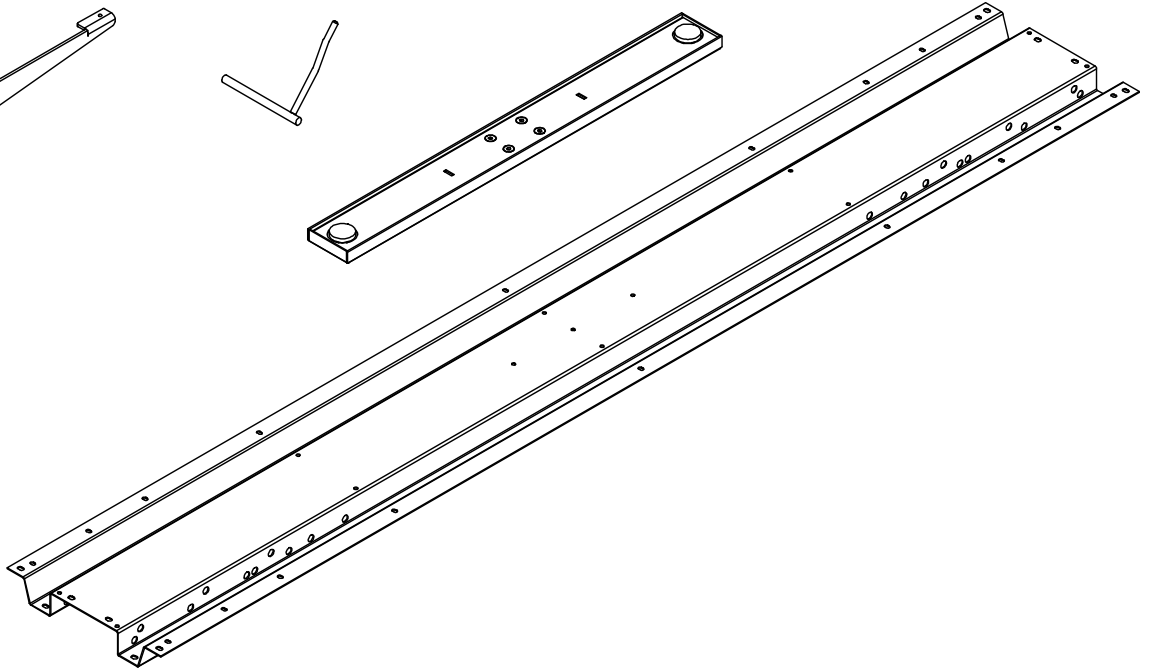

1 xK

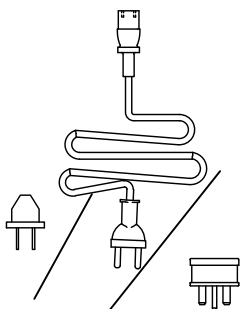

2 xL

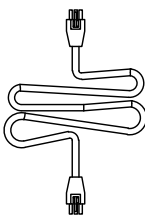

1 xM

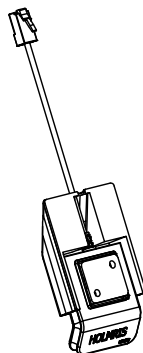

1 xN

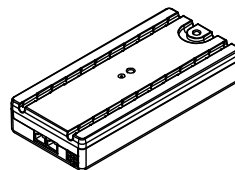

2 xO

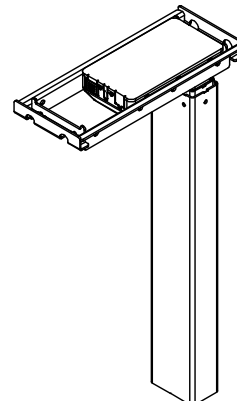

2 xP

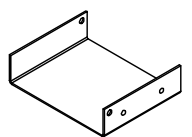

1

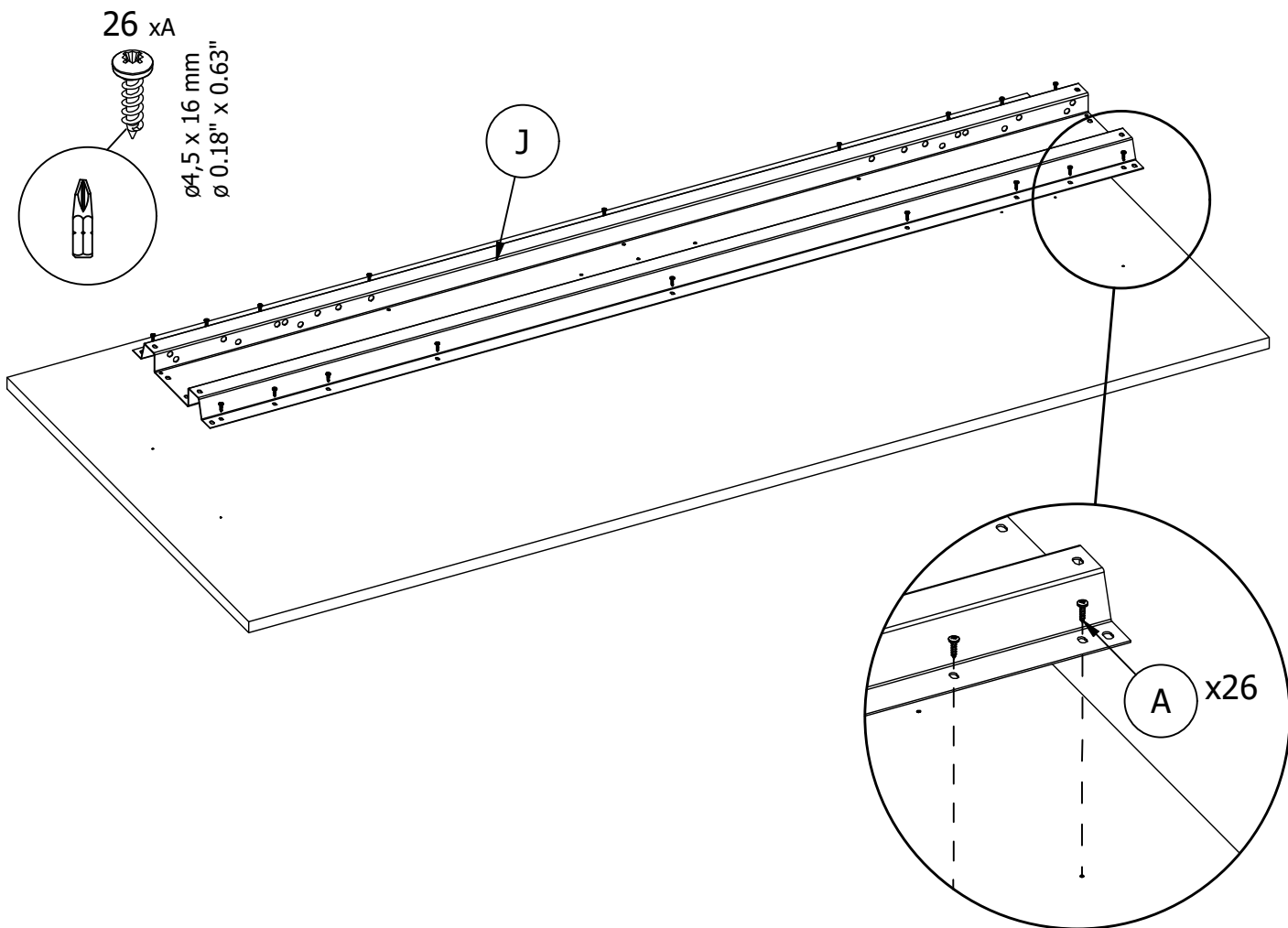

2

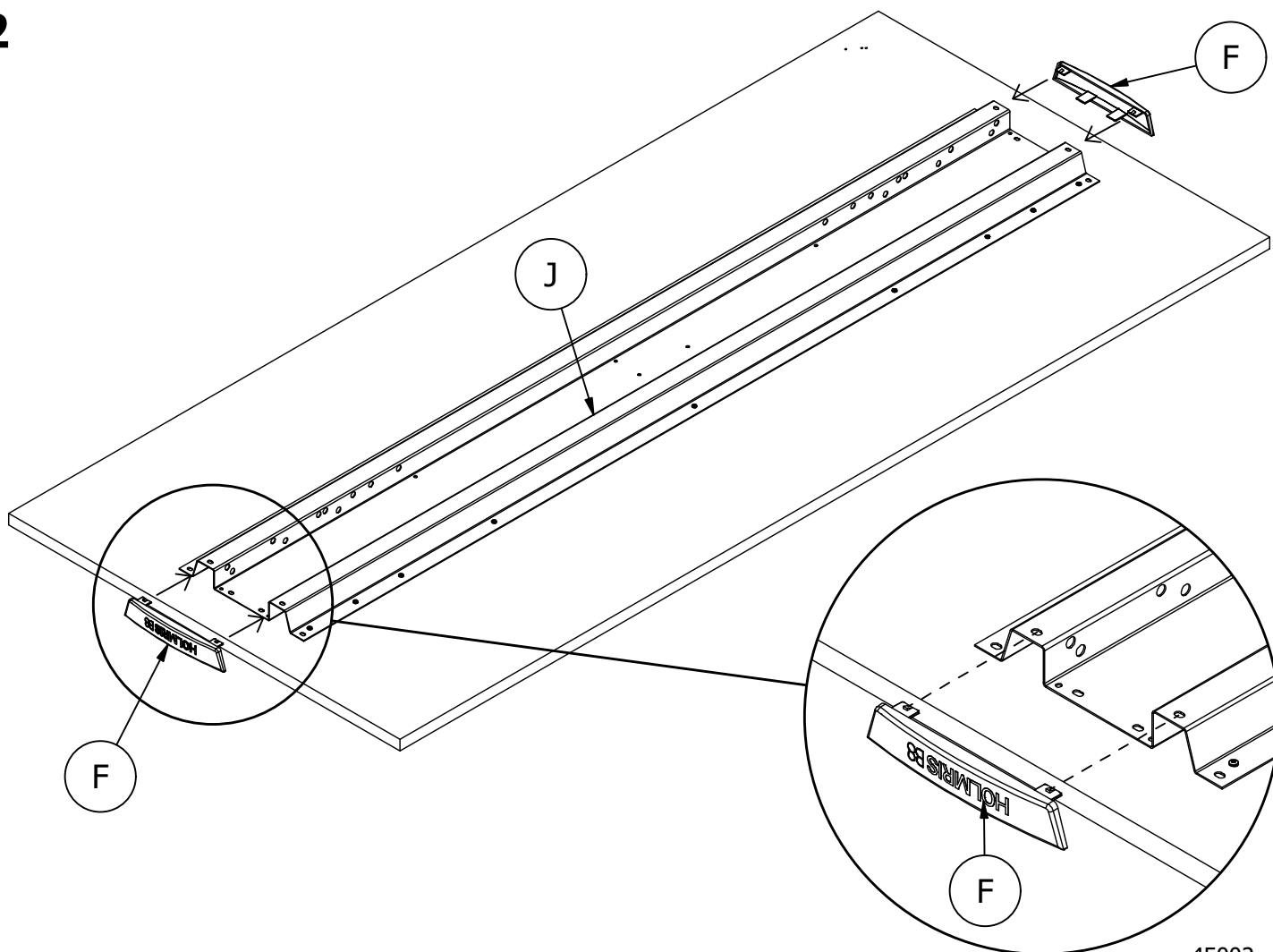

3

Optional

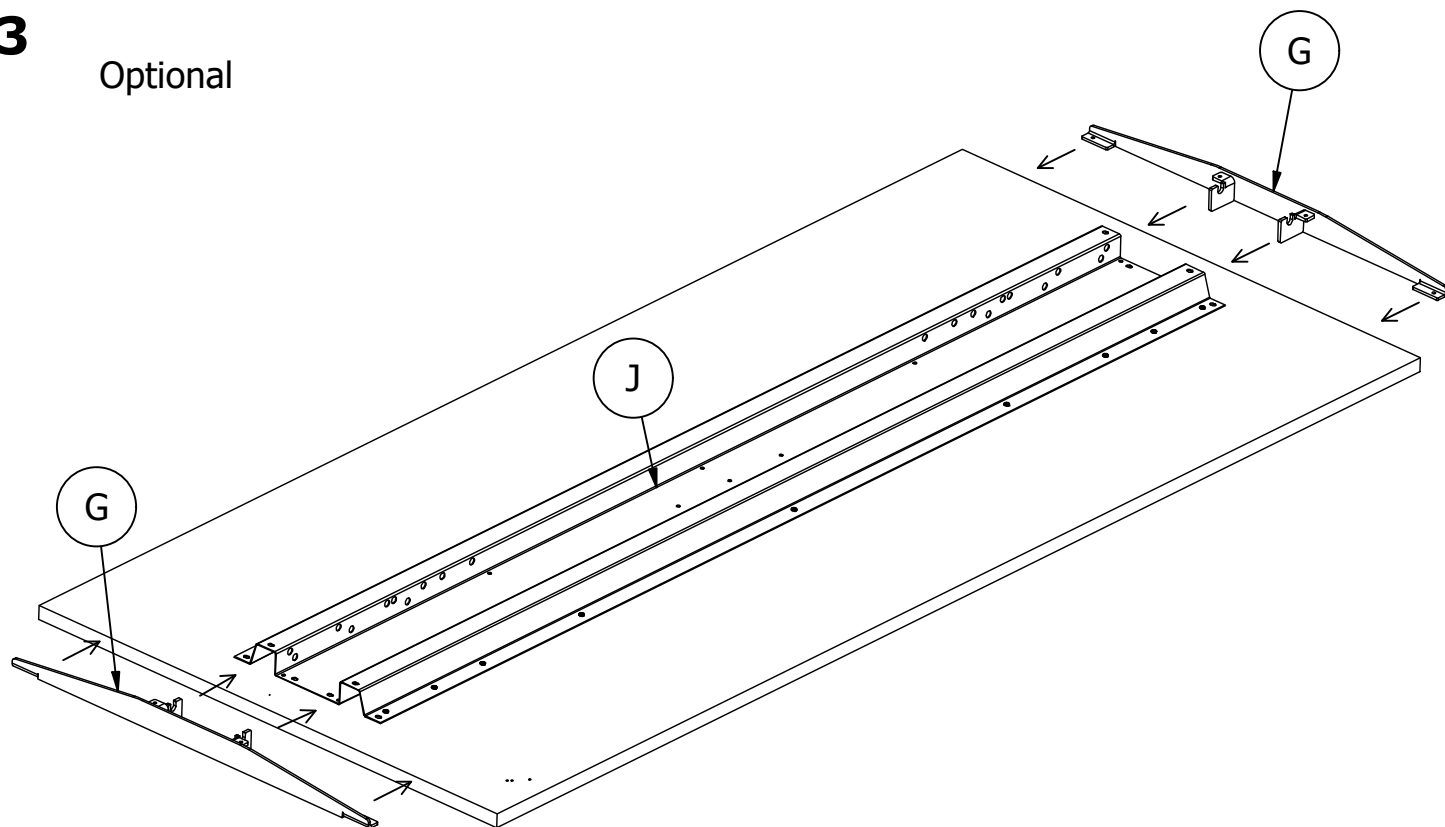

4 xA



Ø4,5 x 16 mm
Ø 0.18" x 0.63"

Optional

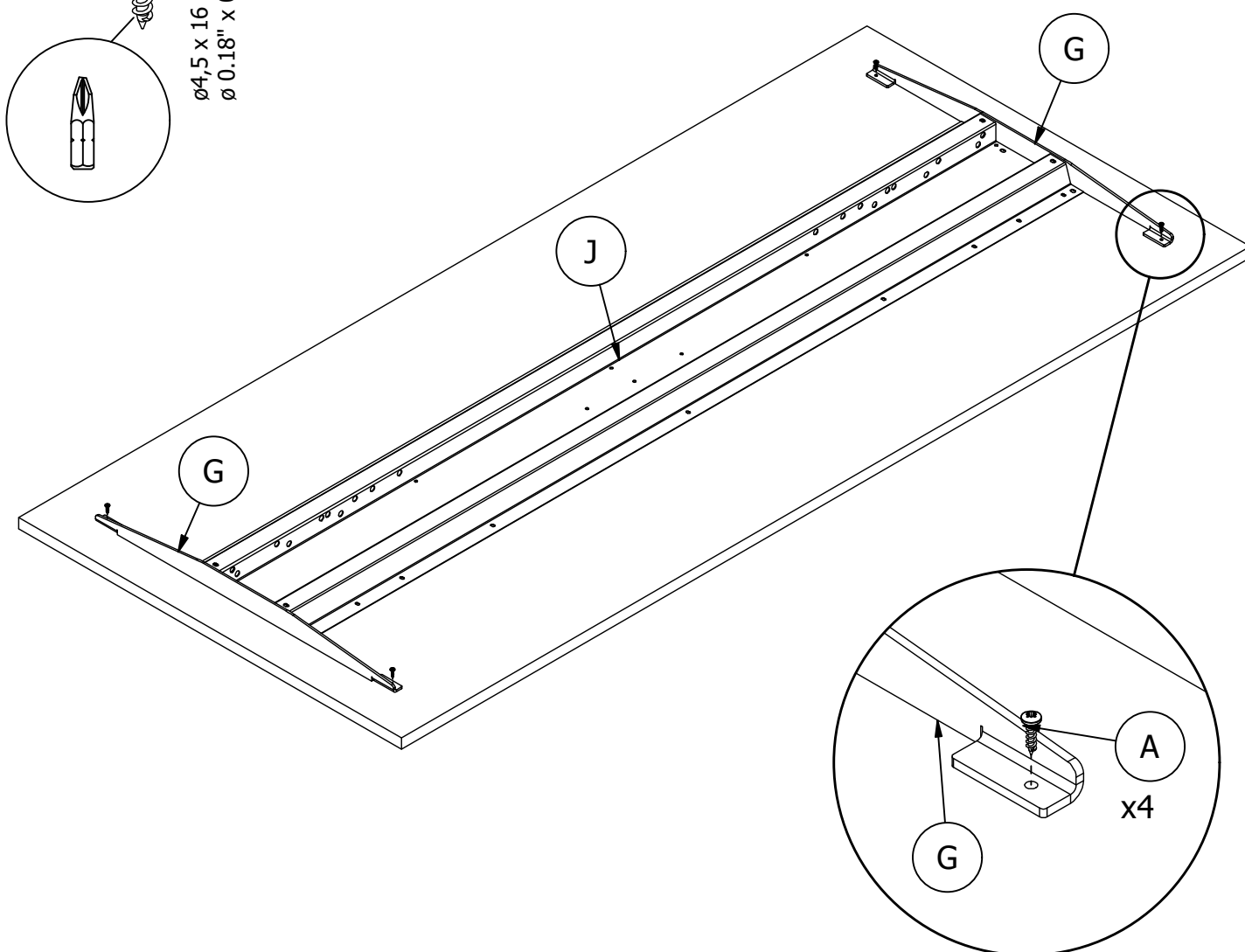

4

1 xK

2 xL

1 xM

1 xN

2 xP

1 xC

26 xA

2 xB

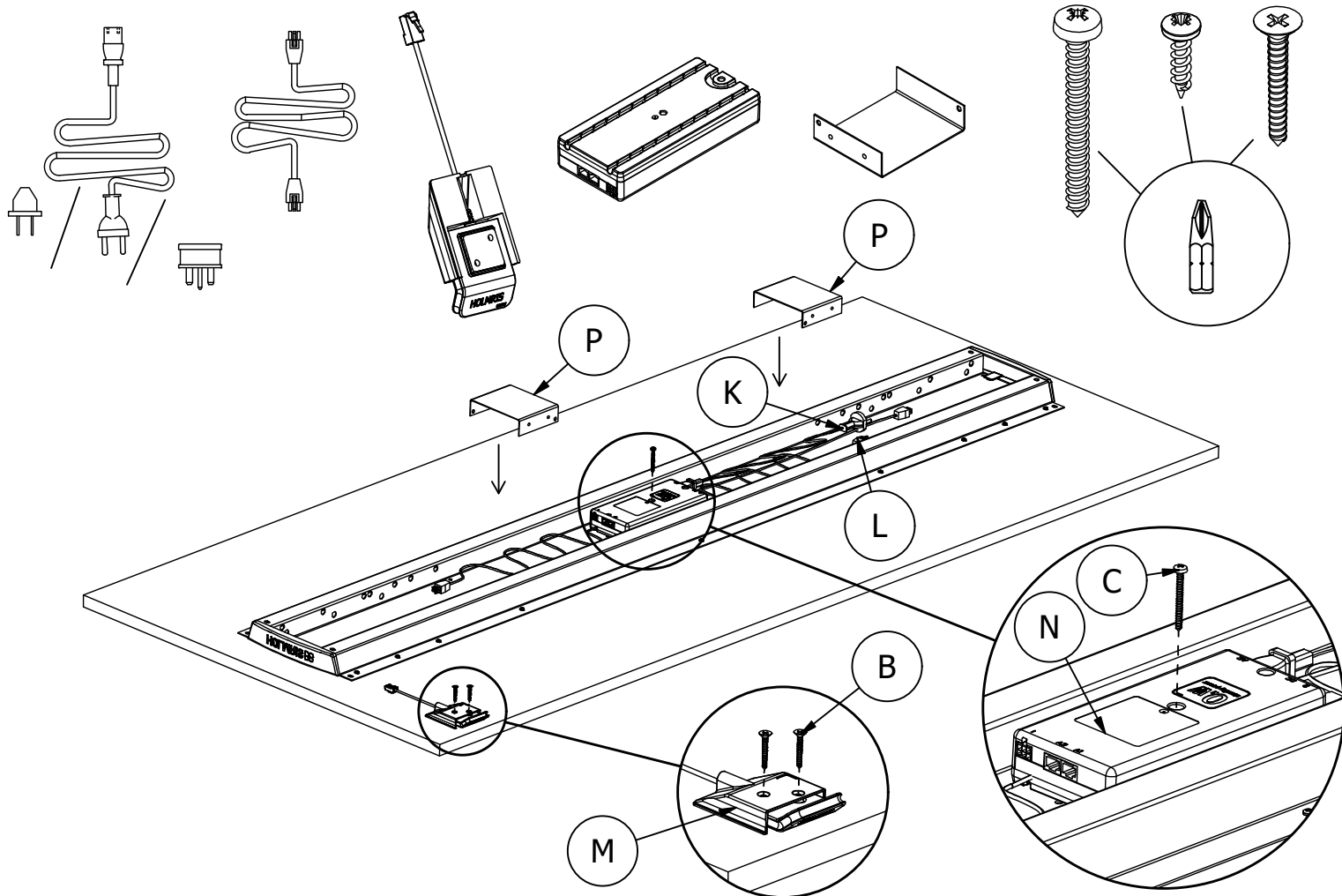

5

8 xD

1 xE

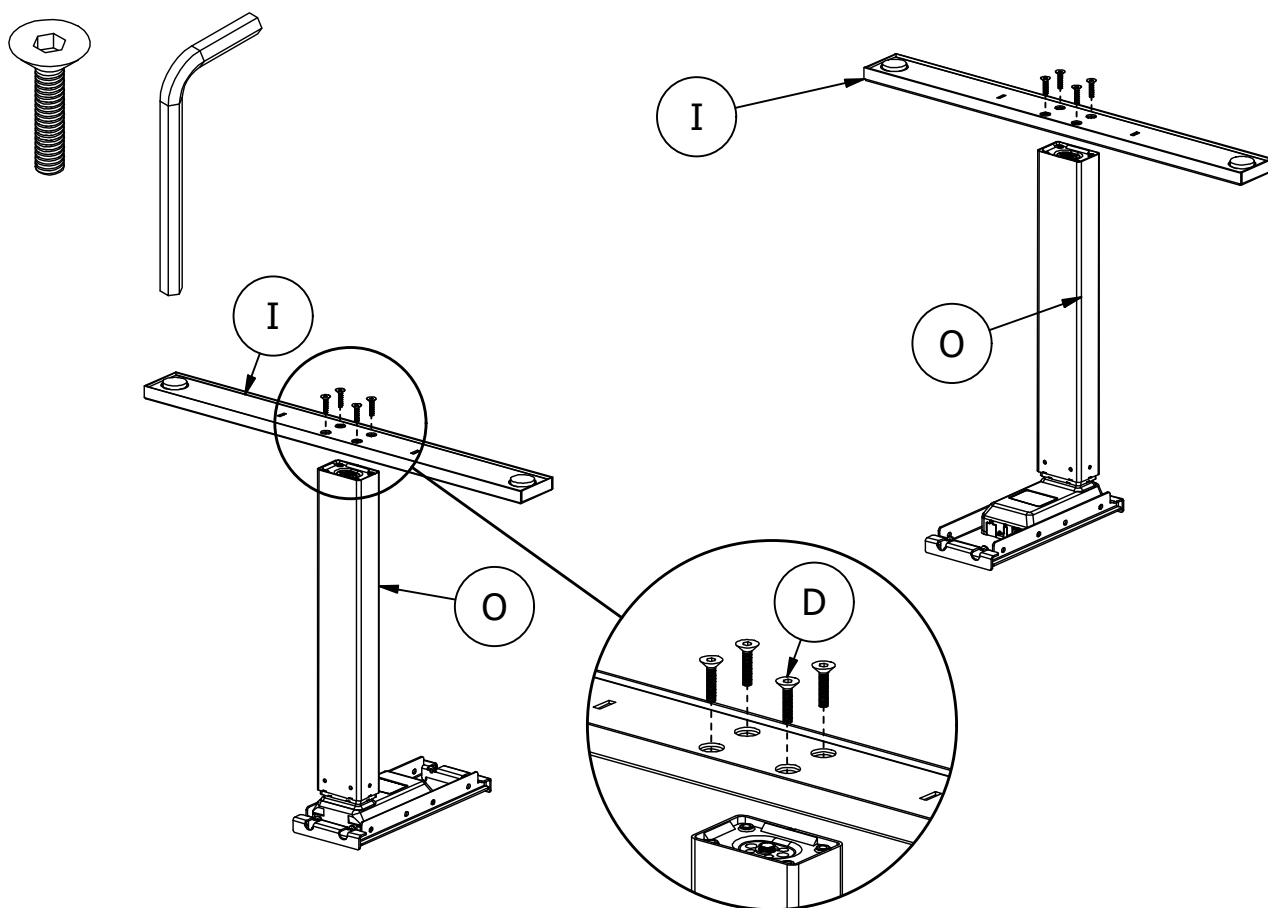

6

4 xH

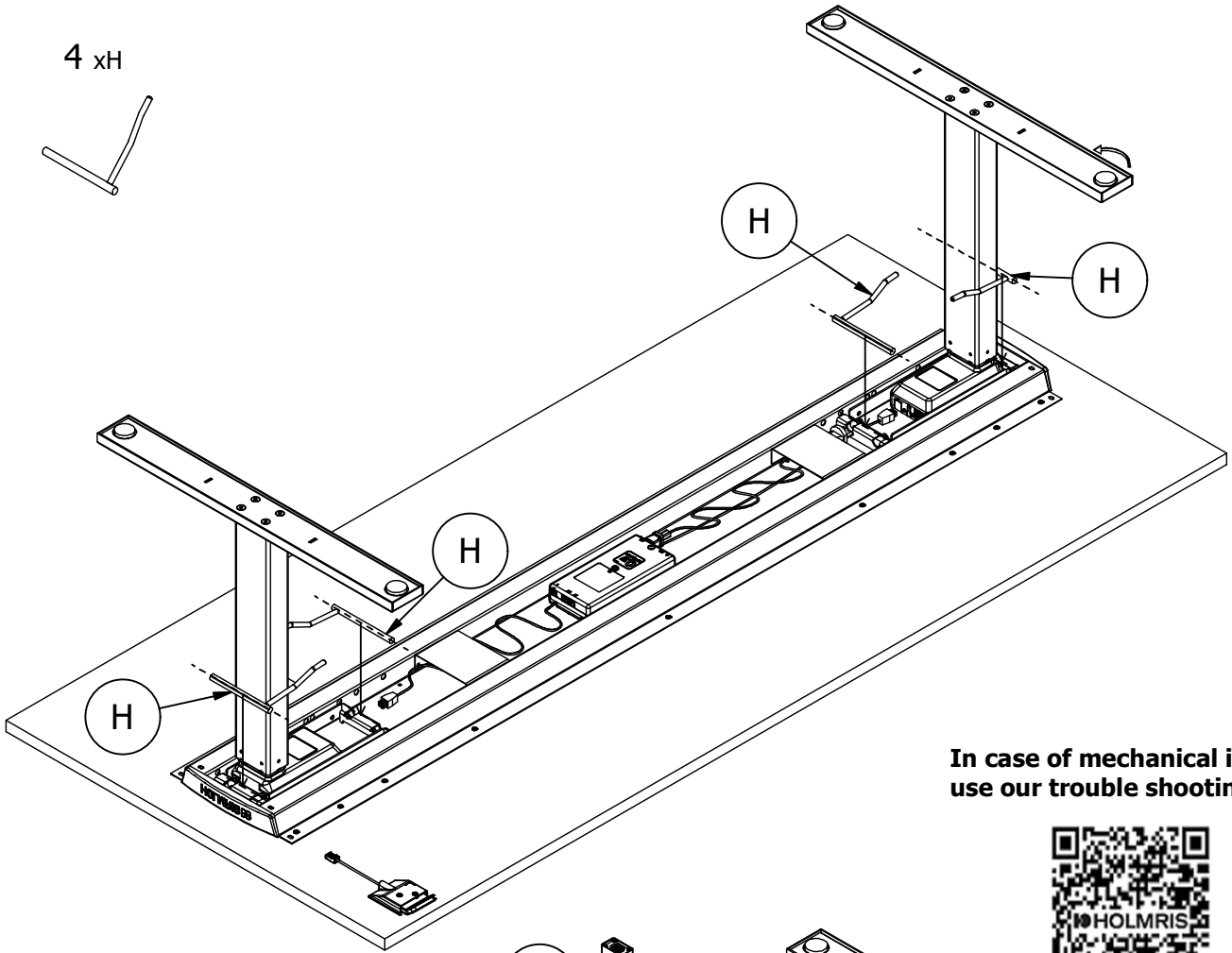
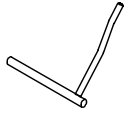

In case of mechanical issues,
use our trouble shooting guide

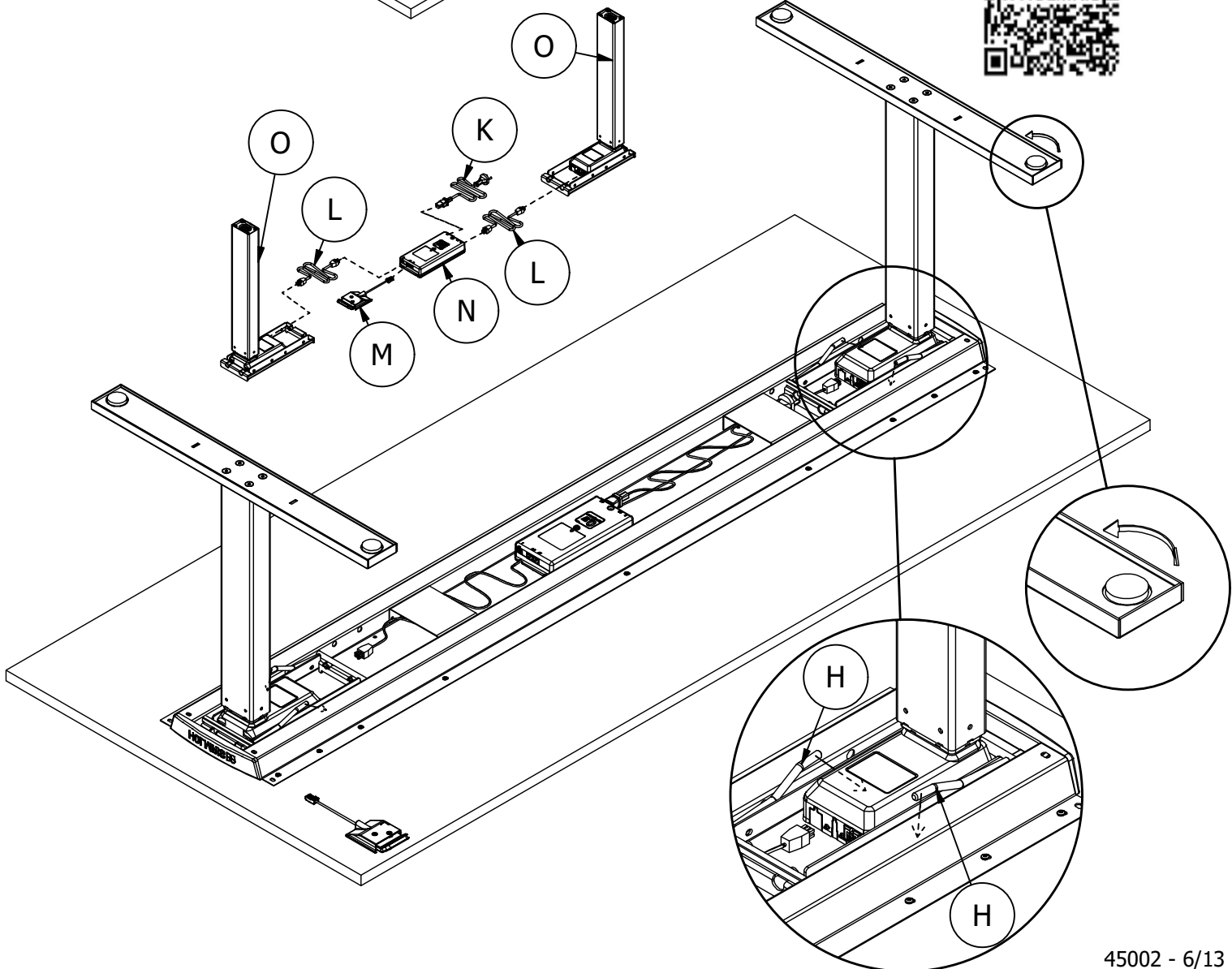

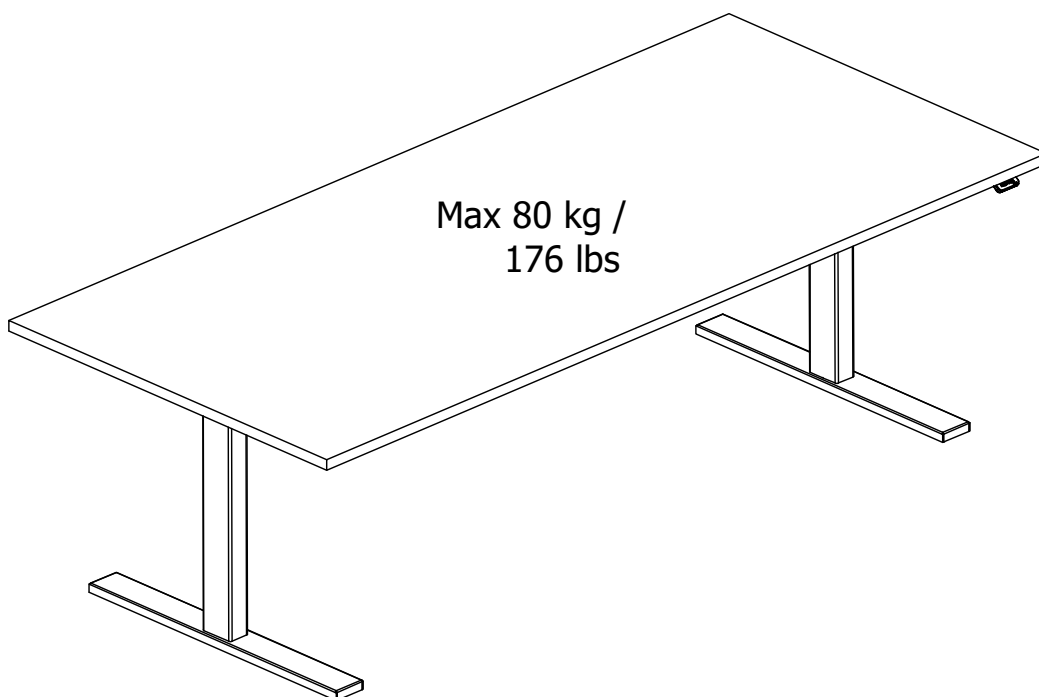
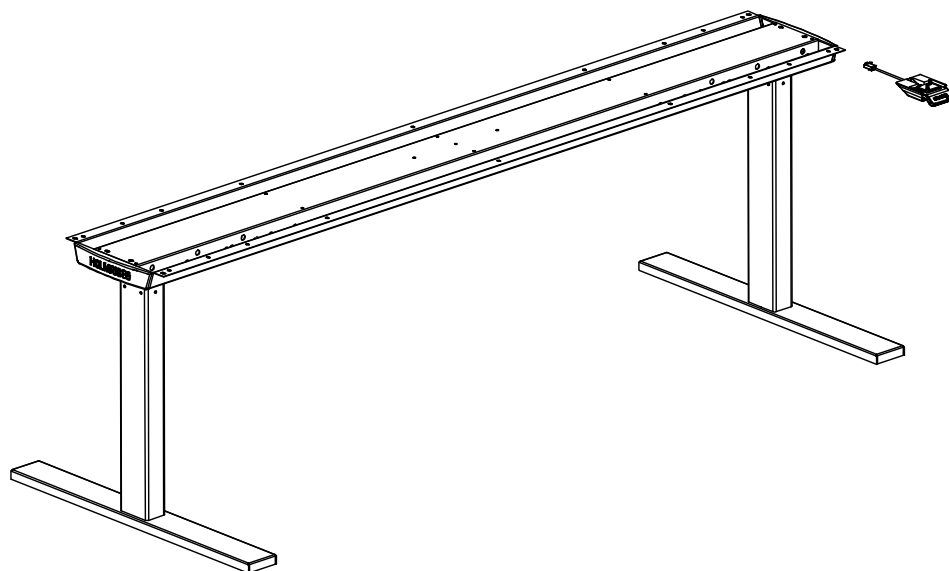

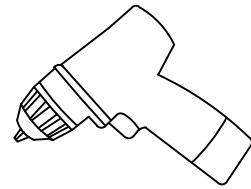
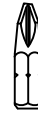
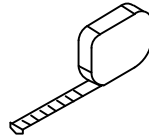
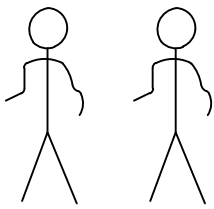

26 xA



ø4,5 x 16 mm
ø 0.18" x 0.63"

2 xB



ø4 x 30 mm
ø 0.16" x 1.18"

8 xC

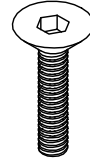

M6 x 25 mm
M 0.24" x 0.47"

1 xD

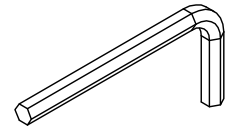

2 xE

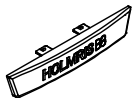

2 xF

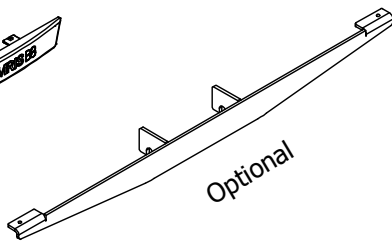

4 xG

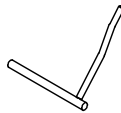

2 xH

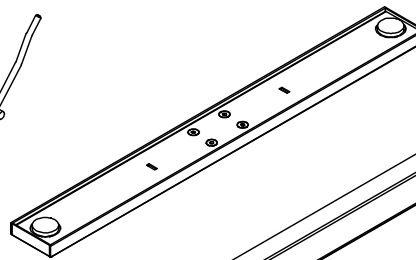

1 xI

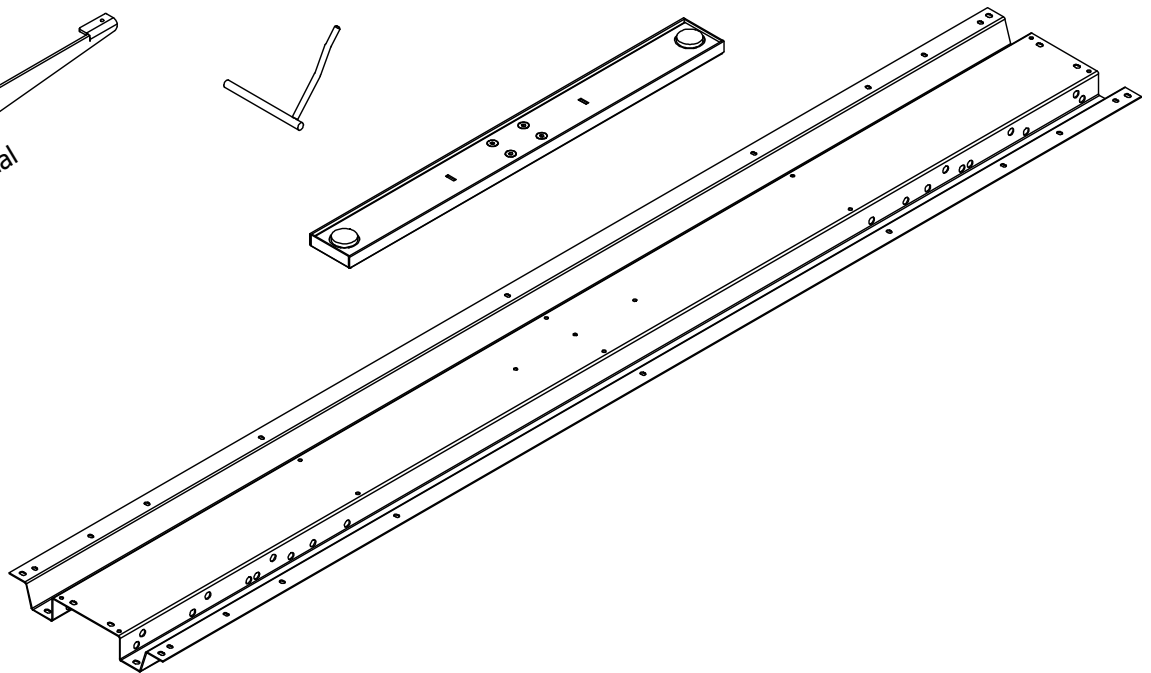

1 xJ

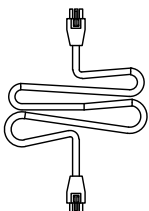

2 xK

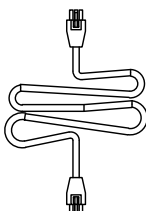

1 xL

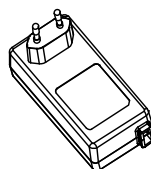

1 xM

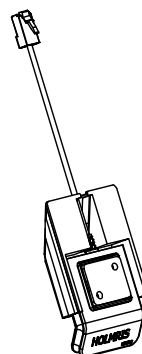

2 xN

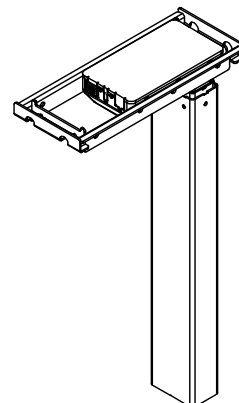

2 xO

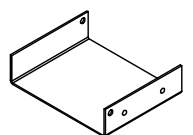

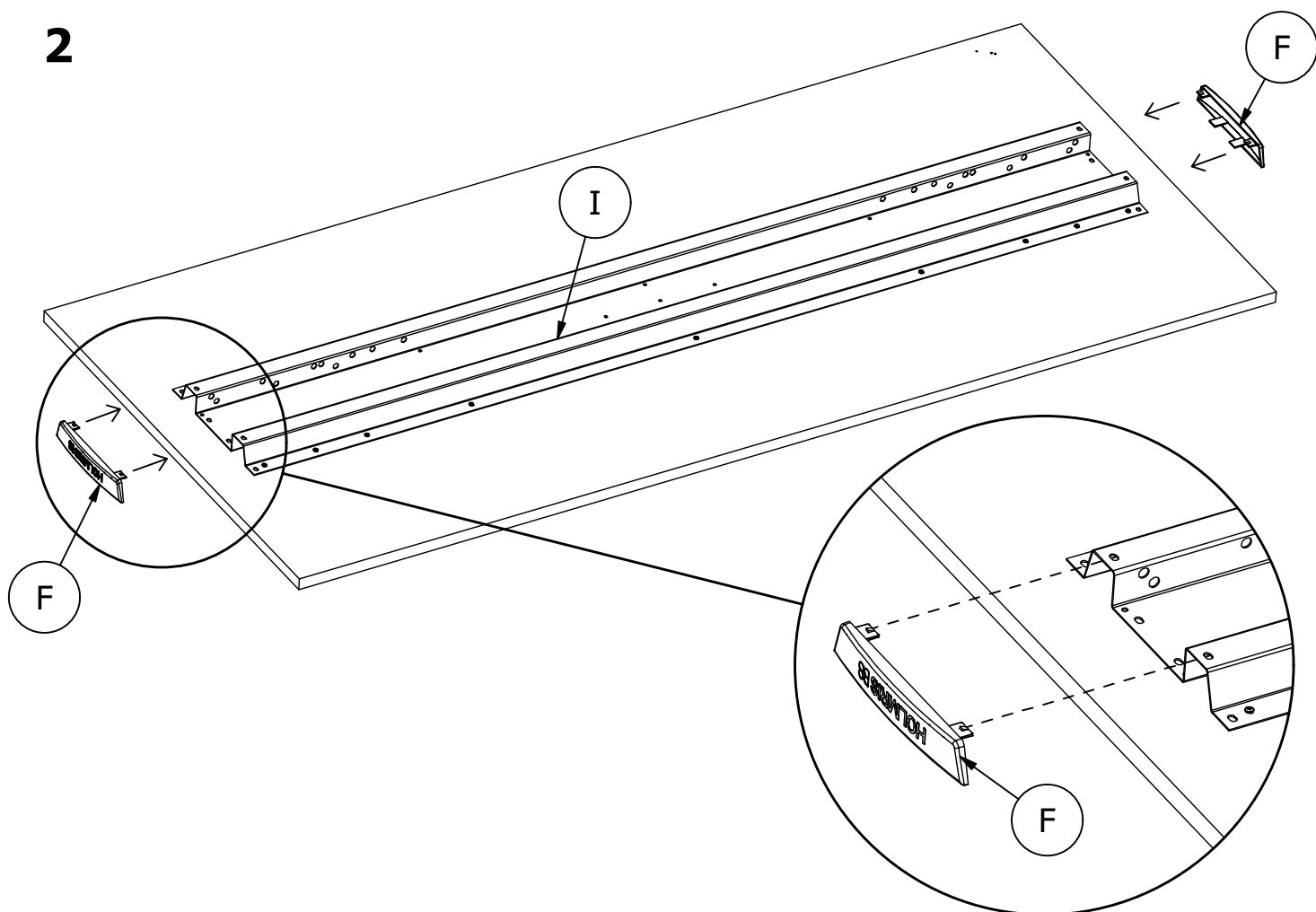
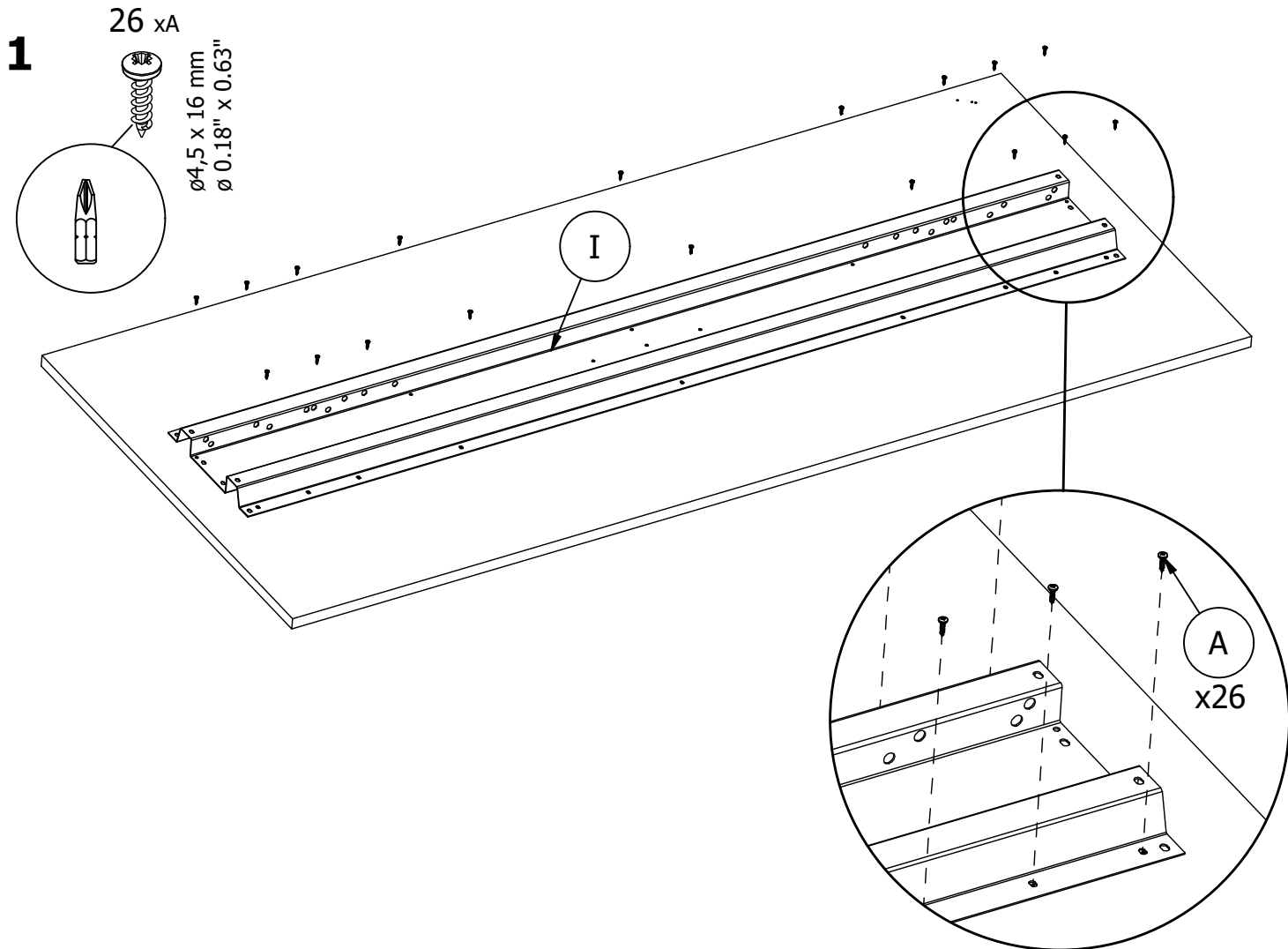

3

Optional

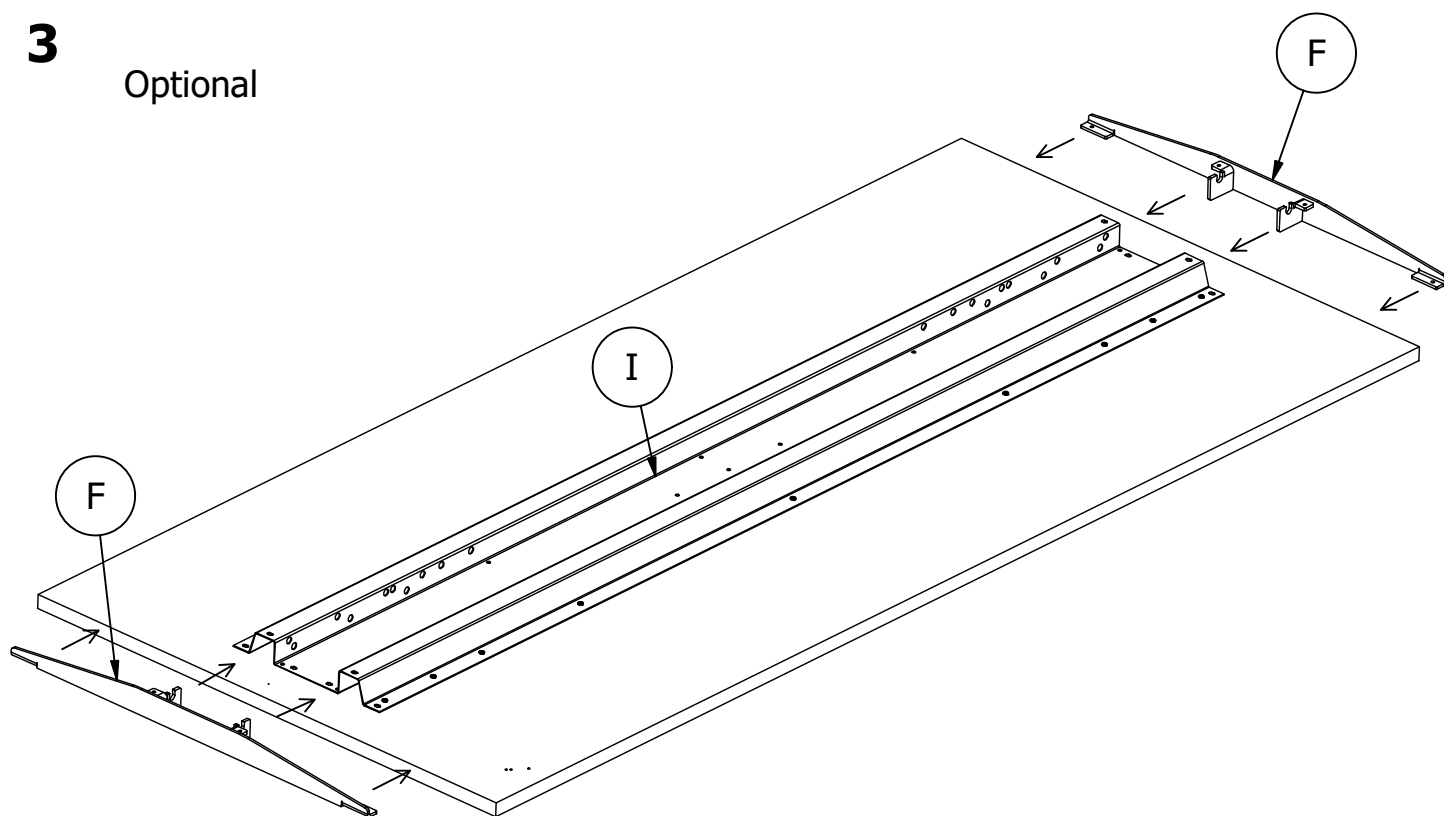

4 x A



Ø4,5 x 16 mm
Ø 0.18" x 0.63"

Optional

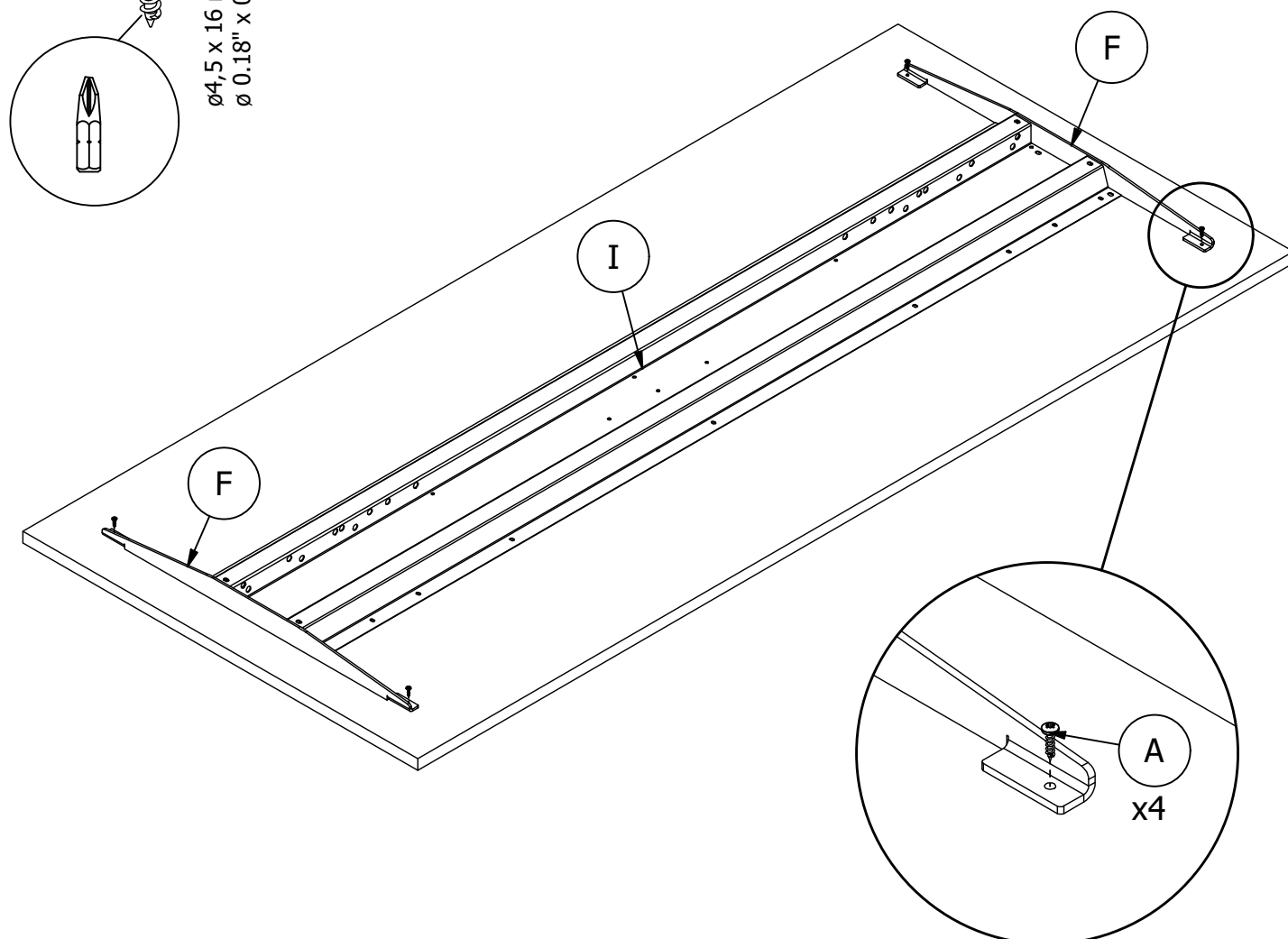

4

1 xJ

1 xK

1 xL

1 xM

2 xO

26 xA

2 xB

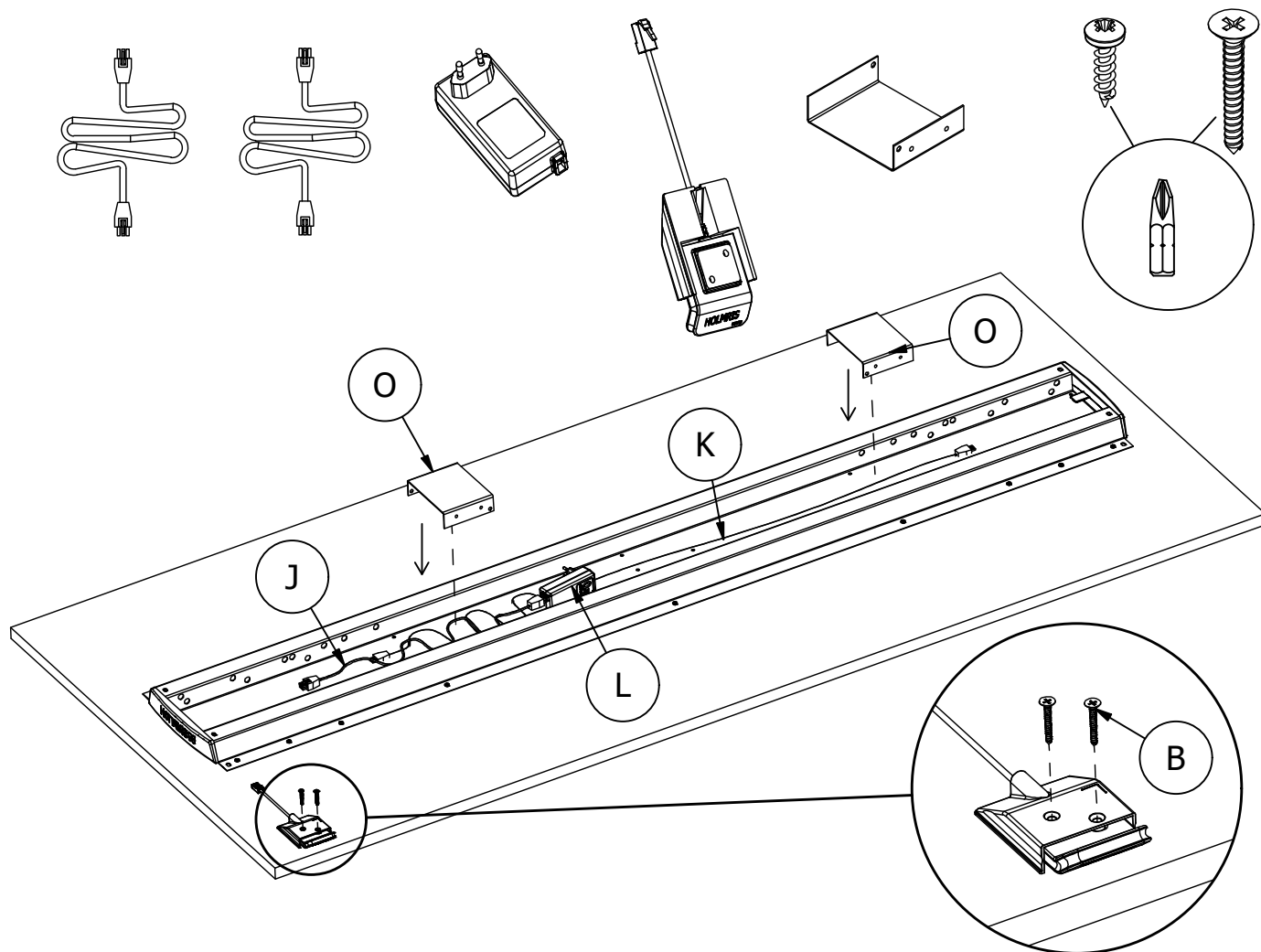

5

8 xC

1 xD

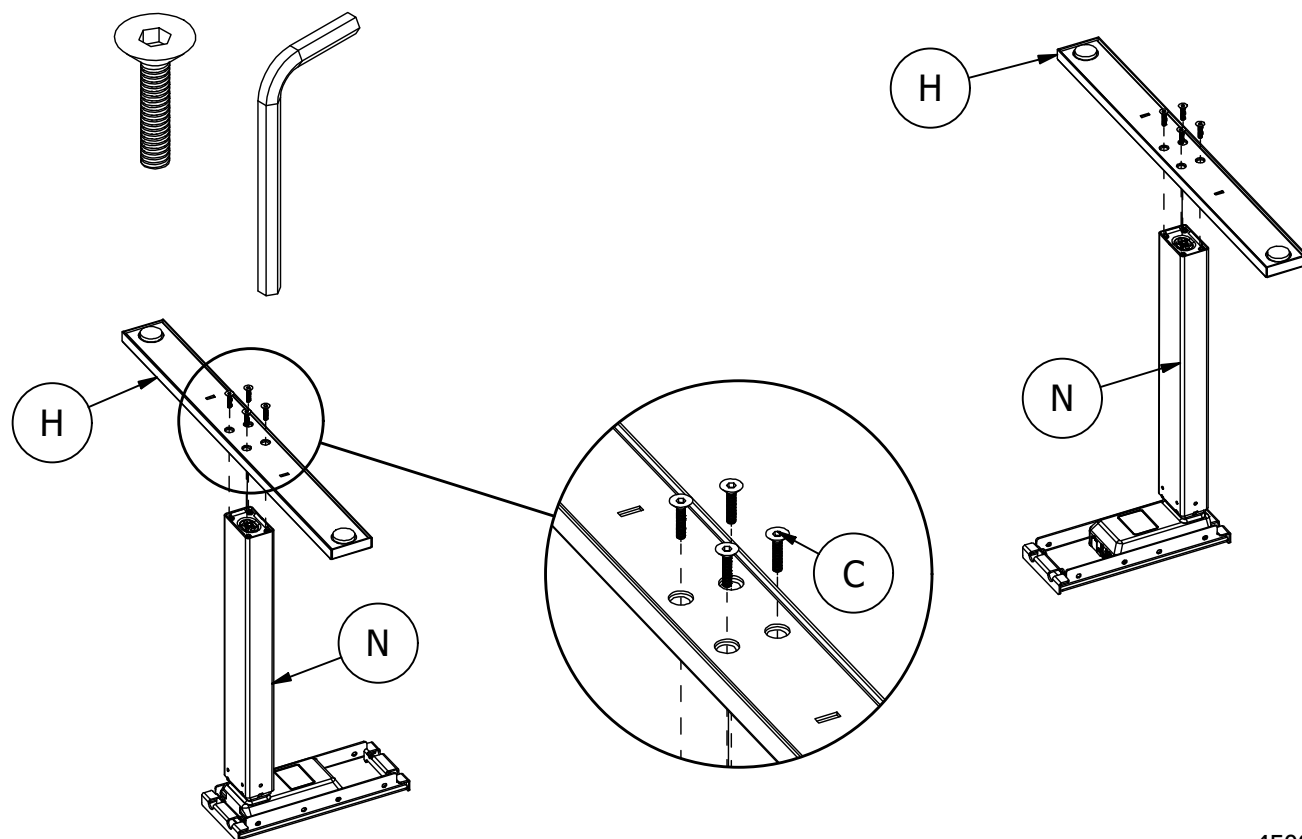

6

4 xG

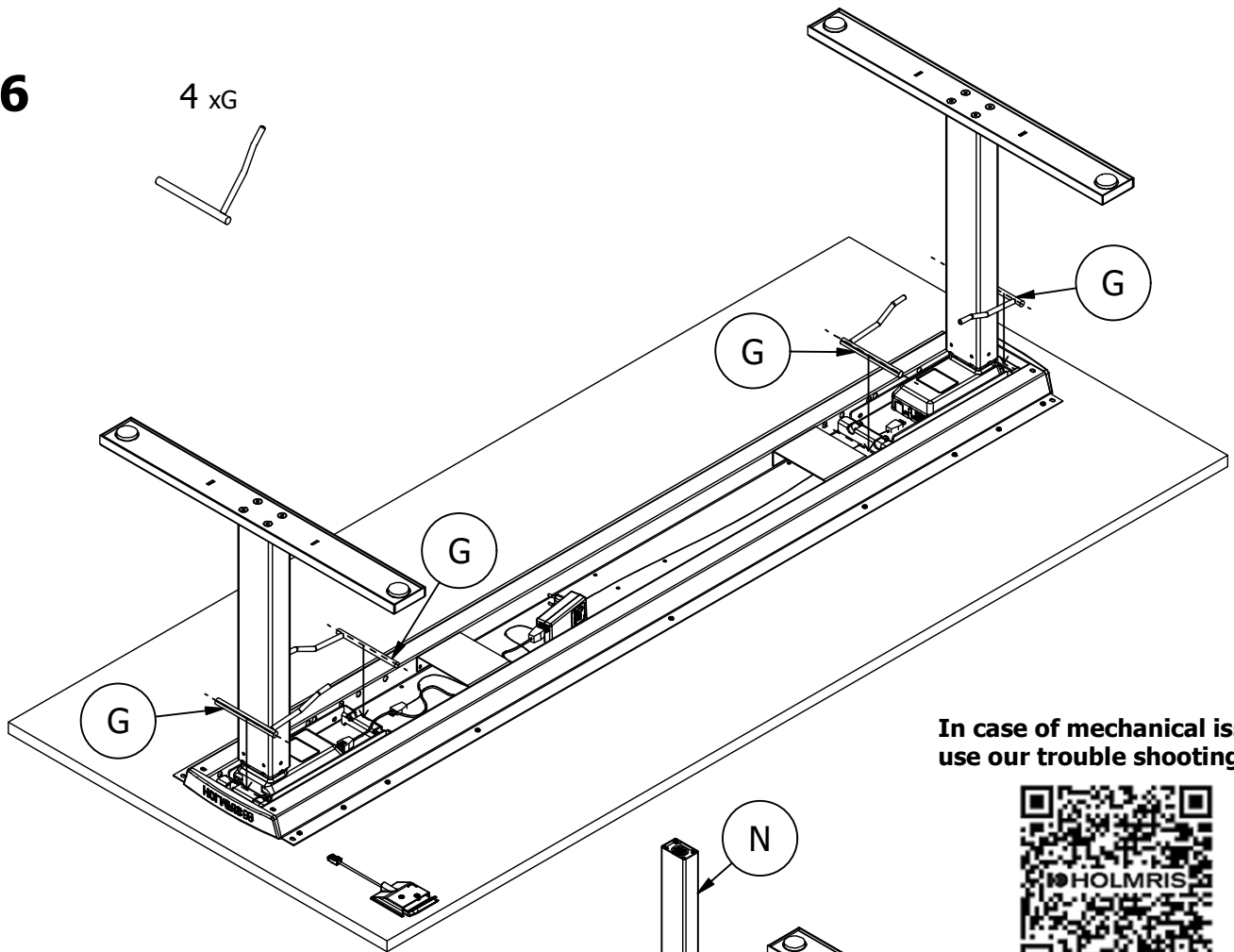
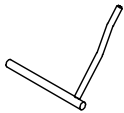

In case of mechanical issues,
use our trouble shooting guide



Master always
positioned in
the same side
as control panel

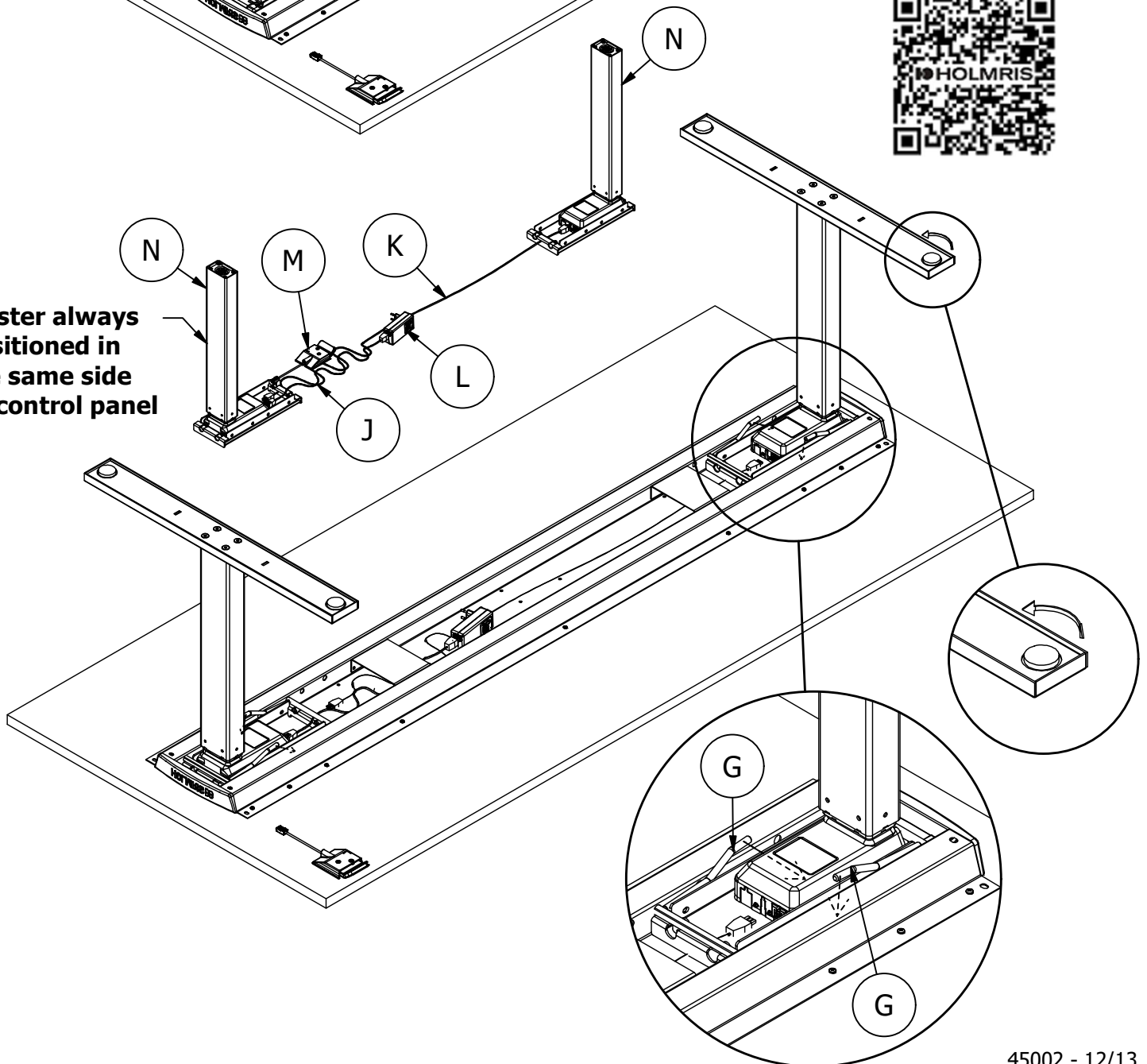

HOLMRIS B8

Furniture Care Instructions

Veneer Product:

The furniture is lacquered and do not require specific care.

Daily cleaning should be done using a soft dry cloth. Once in a while clean with a cloth rinsed with warm water and wrung out tightly.

Linoleum:

Daily cleaning of linoleum should be done using a mild cleaning solution. We recommend using cleaning product with a PH value between 5 and 9 in diluted form. We also recommend using a linoleum care product twice a year.

If very soiled use mild cleaning product to recommended dilution. Follow with clean water and linoleum specific care product.

Laminate:

No specific care required.

Laminate is a plastic product and can be cleaned using most non-abrasive cleaning products.

General:

Never place your furniture in a wet room, or other places with large changes in temperature and moisture. This will compromise the look and life span of the furniture.